

CUSTOMER:

CUSTOMER PART NO.

CONNEXIONS PART NO. ML-5481F8H

DATE 14/03/2007

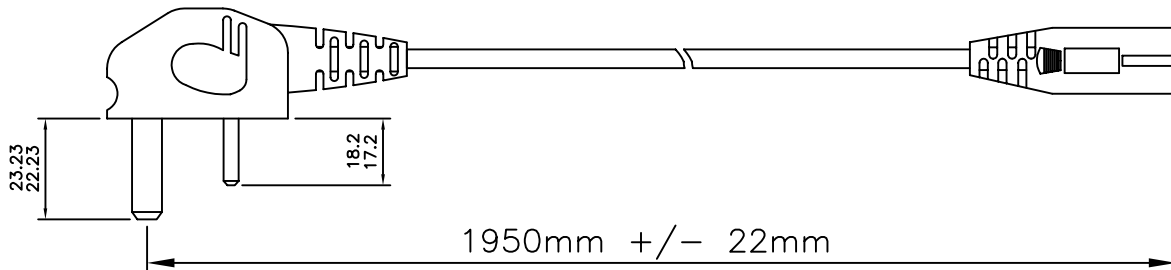
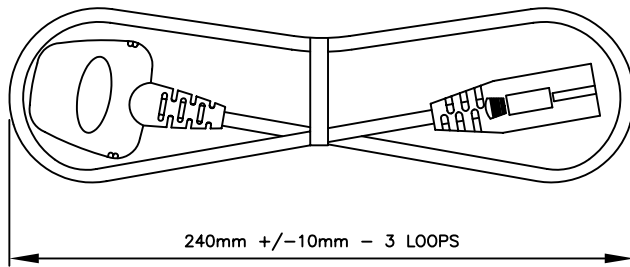

CABLE MARKED 'I-SHENG<VDE>KEMA KEUR+S+S+S<OVE>^CEBEC 809 S D N FI NF-USE
1105 IEMMEQU H03VVH2-F 2x0.75mm² 2LDF/75 Q90096 IEC 227'

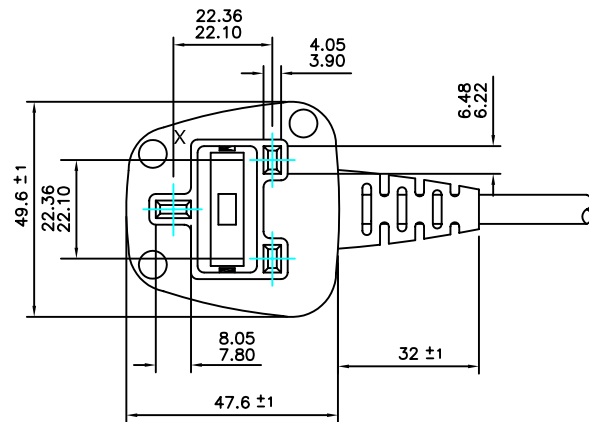

2.5A CONNECTOR COLOUR: BLACK

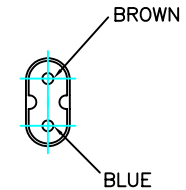
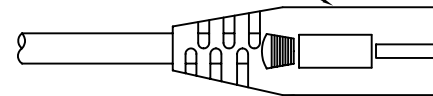

MOULDING INSCRIPTION STATING
'2.5/250 KC-007 APPROVED BY BSI LIC NO KM41331'
KING-CORD

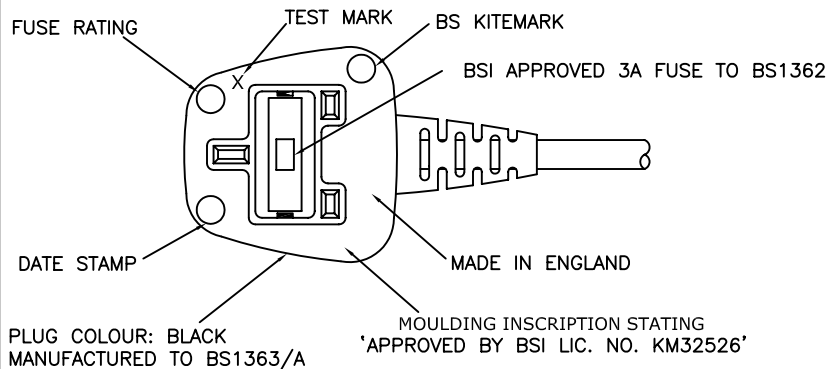
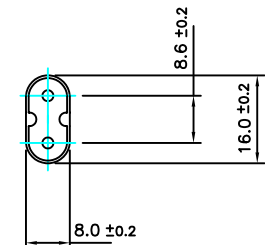
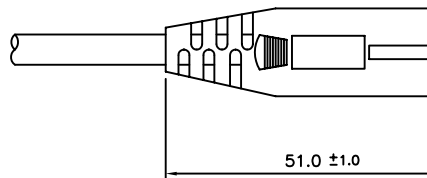

DO NOT SCALE
DIMENSIONS FOR REFERENCE ONLY

2.5A CONNECTOR APPROVALS
BSI UK

UK FULLY MOULDED PLUG (3A FUSED)
H03VVH2-F 2 CORE x 0.75mm²
TO 2.5A SMALL APPLIANCE CONNECTOR
1950mm
BLACK
INDIVIDUALLY HANKED